

DO NOT SCALE. IF IN DOUBT ASK. ALL DIMENSIONS IN MILLIMETRES UNLESS OTHERWISE STATED.

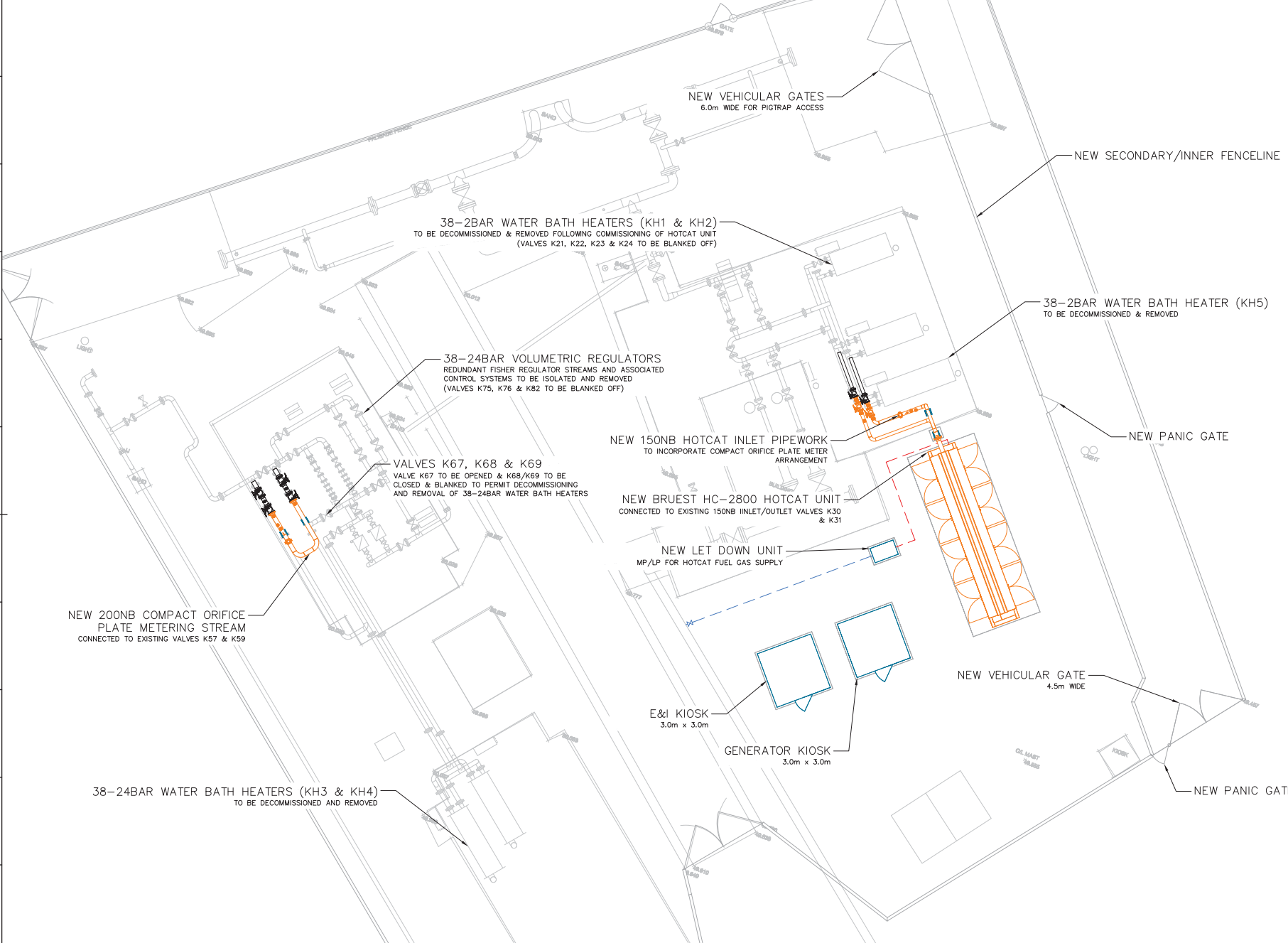

- NOTES**
1. ALL DIMENSIONS ARE IN MILLIMETRES UNLESS OTHERWISE STATED AND ARE TO BE CHECKED PRIOR TO COMMENCEMENT OF FABRICATION.
 2. ALL DIMENSIONS, LEVELS AND ANGLES ARE APPROXIMATE. THE INSTALLATION CONTRACTOR IS RESPONSIBLE FOR CHECKING AND CONFIRMING ALL INDICATED DIMENSIONS, LEVELS AND ANGLES, AND DETERMINING THE POSITION OF ALL SITE WELDS.
 3. THIS DRAWING MUST NOT BE SCALED FOR FABRICATION PURPOSES.
 4. EXISTING SERVICES, PIPEWORK, EQUIPMENT, CABLES, DUCTS AND BUILDINGS WHERE SHOWN ARE FROM EXISTING RECORDS AS PROVIDED BY NORTHERN GAS NETWORKS. INSTALLATION CONTRACTOR TO LOCATE AND CONFIRM ANY EXISTING SERVICES AND EQUIPMENT PRIOR TO CONSTRUCTION.
 5. BELOW GROUND PIPE TO BE BEDDED ON AND SURROUNDED BY SAND FINEILL VOID OF SHARP OBJECTS THAT MAY DAMAGE TO THE PIPEWORK COATING.
 6. SOIL WITH LOW GROUND BEARING CAPACITY TO BE REMOVED AND REPLACED WITH SUITABLY COMPACTED TYPE 1.
 7. ALL AREAS DISTURBED BY WORKS ARE TO BE MADE GOOD BY THE INSTALLATION CONTRACTOR TO THE SATISFACTION OF NORTHERN GAS NETWORKS. SITE FINISH TO BE AS EXISTING TO INCLUDE THE PROFILING OF SLOPES AS NECESSARY.
 8. DESIGN GENERALLY IN ACCORDANCE WITH THE RECOMMENDATIONS OF ISEM/TD/13, AND SPECIFICATIONS NGN/SP/E/28 & NGN/SP/PW/11.
 9. ALL PIPEWORK AND EQUIPMENT FOR DESIGN PRESSURES ABOVE 7 BAR SHALL BE CONSTRUCTED IN ACCORDANCE WITH SPECIFICATION NGN/SP/PW/11, WELDED IN ACCORDANCE WITH NGN/SP/P/12 AND TESTED IN ACCORDANCE WITH NGN/SP/PT/1. ANY DEVIATION FROM THESE SPECIFICATIONS SHALL BE AGREED IN ADVANCE IN WRITING WITH NORTHERN GAS NETWORKS.
 10. ALL PIPEWORK AND EQUIPMENT FOR DESIGN PRESSURES BELOW 7 BAR SHALL BE CONSTRUCTED IN ACCORDANCE WITH SPECIFICATION NGN/SP/MSL/1, WELDED IN ACCORDANCE WITH NGN/SP/P/11 AND TESTED IN ACCORDANCE WITH NGN/SP/MSL/1. ANY DEVIATION FROM THESE SPECIFICATIONS SHALL BE AGREED IN ADVANCE IN WRITING WITH NORTHERN GAS NETWORKS.
 11. ALL PIPE WORK TO BE THOROUGHLY CLEANED INTERNALLY AND EXTERNALLY BEFORE COMMISSIONING.
 12. SUITABLE TEMPORARY SUPPORTS SHOULD BE INSTALLED FOR EXISTING PIPEWORK AS REQUIRED.
 13. ALL LIFTING OPERATIONS TO BE AGREED IN ADVANCE WITH NORTHERN GAS NETWORKS.

Rev	0	Description
Date	17/10/2014	ISSUED FOR TENDER
Drn by	RCS	
Chk by	AI	
Apr by	RW	

Kilmore Street
Leeds
LS10 1BD
0113 276 8200

Project Title: KNOTTINGLEY	
Sheet 01/01	Scale @ A1 1:100
Drawn By RCS	Date 17/10/2014
Checked By AI	Drn No: RCS/2010270/KNOTTINGLEY/P/002
Approved By RW	Proj No: 0

Site: KNOTTINGLEY
Title: KNOTTINGLEY AGI PROPOSED SITE LAYOUT
Drn No: RCS/2010270/KNOTTINGLEY/P/002
Proj No: 0